

### STANDARD CONSTRUCTION

#### CONSTRUCTION

- ALL WELDED

#### FRAME

- 4.00in x .081in [102mm x 2.1mm] EXTRUDED ALUMINUM (6063-T5) CHANNEL FRAME

#### BLADES

- Z STYLE BLADES, .081in[2.1mm] EXTRUDED ALUMINUM (6063-T5) 45° BLADE ANGLE, 5.00in[127mm] BLADE SPACING

#### FINISH

- MILL

#### MINIMUM SECTION SIZE

- 9.00in W x 10.50in H [229mm x 267mm]

#### MAXIMUM SECTION SIZE

- ONE PIECE CONSTRUCTION 72in W x 120in H [1829mm x 3048mm] OR 120in W x 72in H [3048mm x 1829mm]
- LARGER LOUVERS WILL REQUIRE FIELD ASSEMBLY OF MULTIPLE SECTIONS AND MAY REQUIRE ADDITIONAL STRUCTURAL SUPPORT BY OTHERS.
- INSTALLATION HARDWARE & STRUCTURAL REINFORCING MEMBERS ARE NOT PROVIDED BY PRICE UNLESS OTHERWISE INDICATED.



**SIZING**  NOMINAL  ACTUAL

**FRAME**  CHANNEL  FLANGED

#### FINISHES

- MILL  PRIME COAT
- BAKED ENAMEL [1]
- 70% PVDF [1]
- 70% PVDF WITH CLEAR TOP COAT [1]
- CLEAR ANODIZED  COLOUR ANODIZED [1]

#### ACCESSORIES

- BIRD SCREEN  BIRD SCREEN WITH FRAME
- INSECT SCREEN
- EXTENDED SILL (LOOSE)
- BLANK-OFF PANELS
  - INSULATED  NON-INSULATED

[1] REFER TO PRICE COLOUR GUIDES FOR A LIST OF AVAILABLE STANDARD COLOURS: [PAINT & ANODIZED](#)  
CONSULT PRICE LOUVERS DEPT. FOR OTHER SPECIAL REQUIREMENTS

#### MULTI-SECTION ASSEMBLY

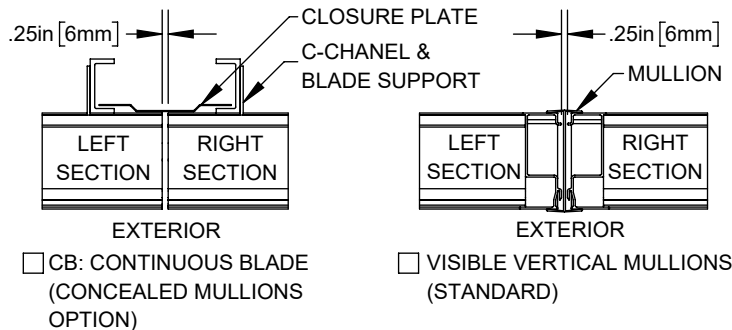

CHANNEL FRAME "A" MOUNTING SHOWN [274240](#)  
FOR OTHER MOUNTING METHODS SEE

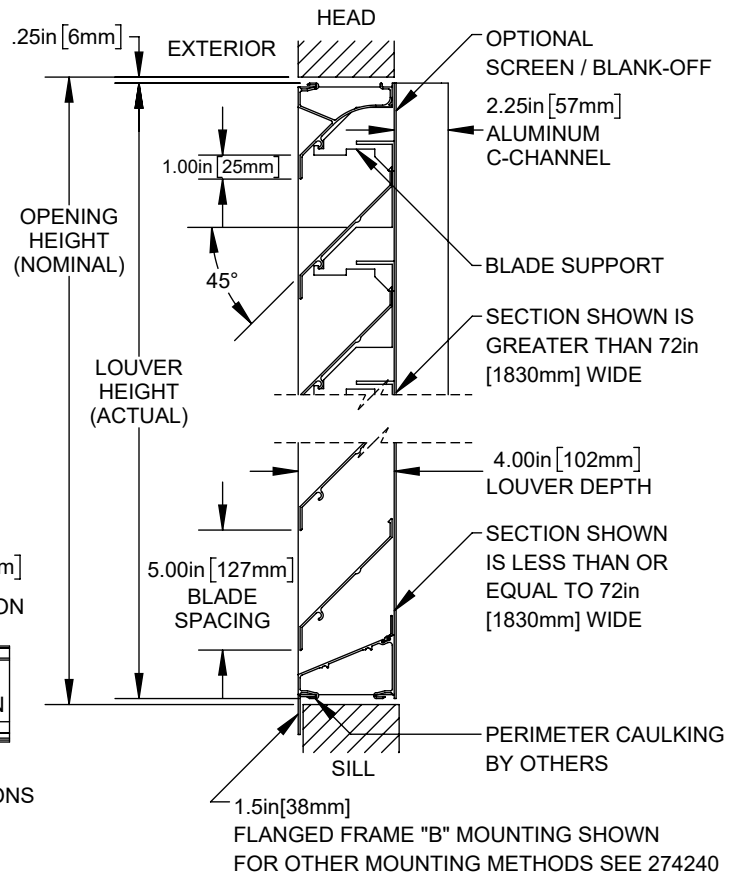

<b>PROJECT:</b>		<b>PRICE</b> <sup>®</sup>	
<b>ENGINEER:</b>		JVN	<b>ZE445</b> 4" (102) DEEP, 45° BLADE EXTRUDED NON-DRAINABLE LOUVER
<b>CUSTOMER:</b>		243555	
<b>SUBMITTAL DATE:</b>	<b>SPEC. SYMBOL:</b>	2025-07-18	